

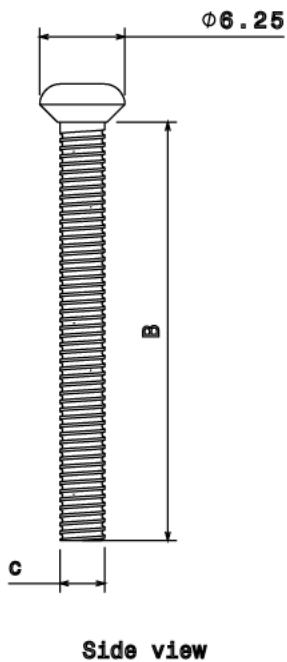

## MH40 - M3.5 X 40MM CSK N/PLATED SCREW -

<b>Description</b>	MH40 - Switch & Socket Box Screws M3.5 x 40mm Raised Countersunk
<b>Finish</b>	Nickel Plated
<b>Material</b>	Steel
<b>Packaging</b>	Packed in qty 100
<b>Additional Notes</b>	For use with Switch & Socket Boxes

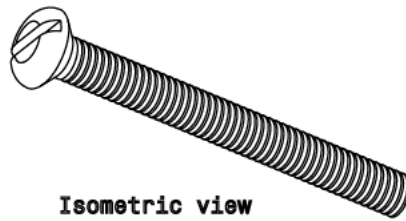
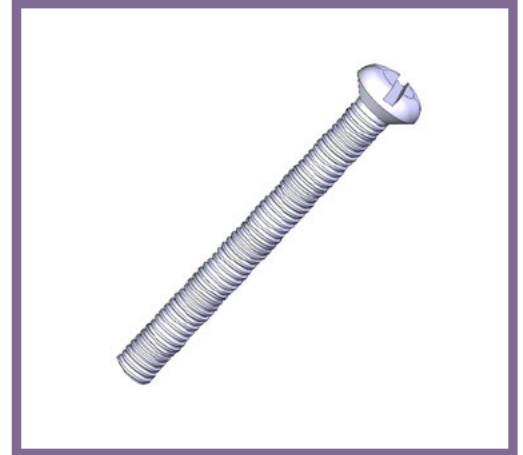

Code	A	B	C
MH20	6.25MM	20MM	3.5MM
MH25	6.25MM	25MM	3.5MM
MH35	6.25MM	35MM	3.5MM
MH40	6.25MM	40MM	3.5MM
MH50	6.25MM	50MM	3.5MM
MH75	6.25MM	75MM	3.5MM

All measurements in mm unless otherwise stated